

TREATED WATER TANK & FOUNDATION PLAN

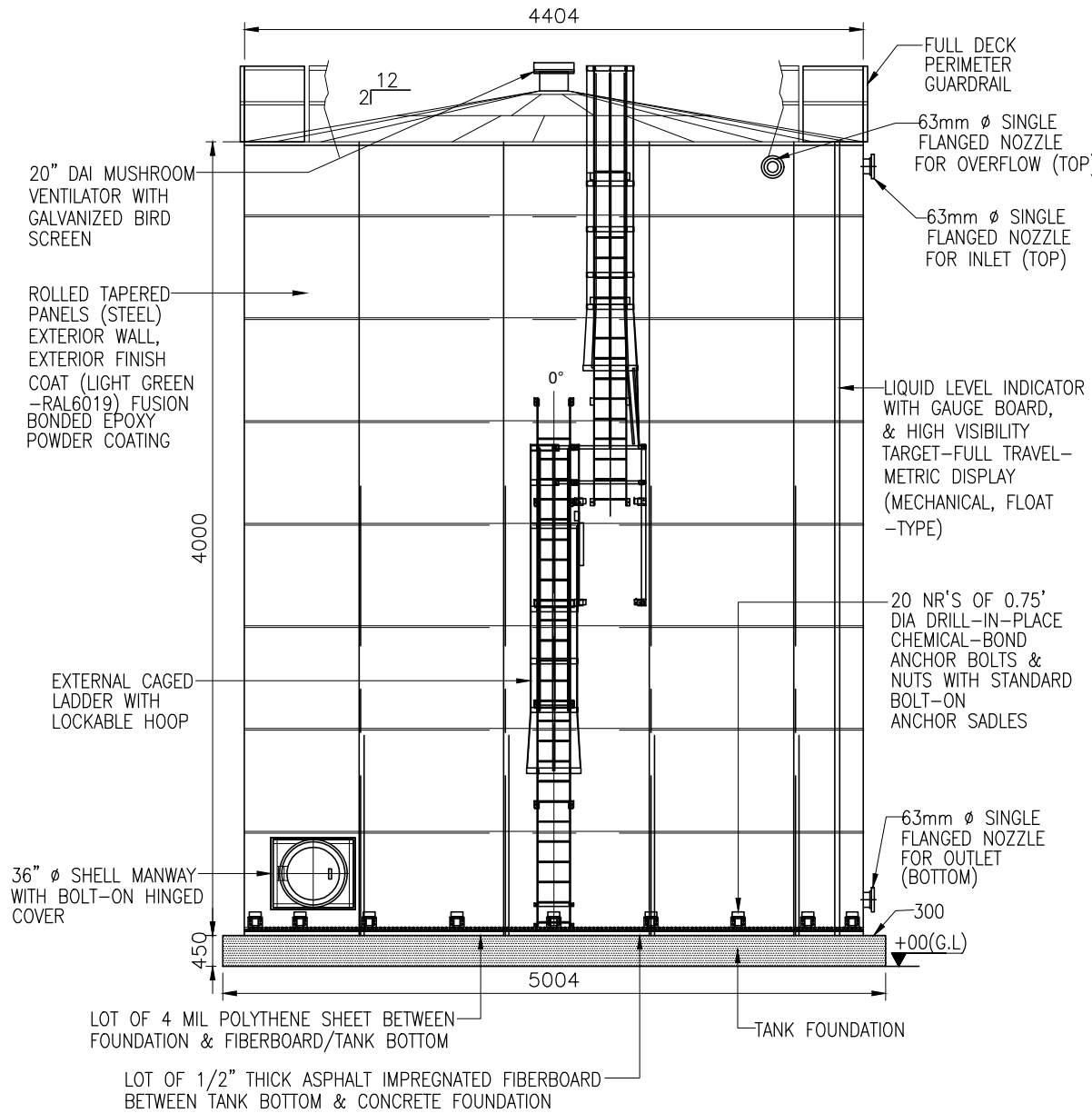
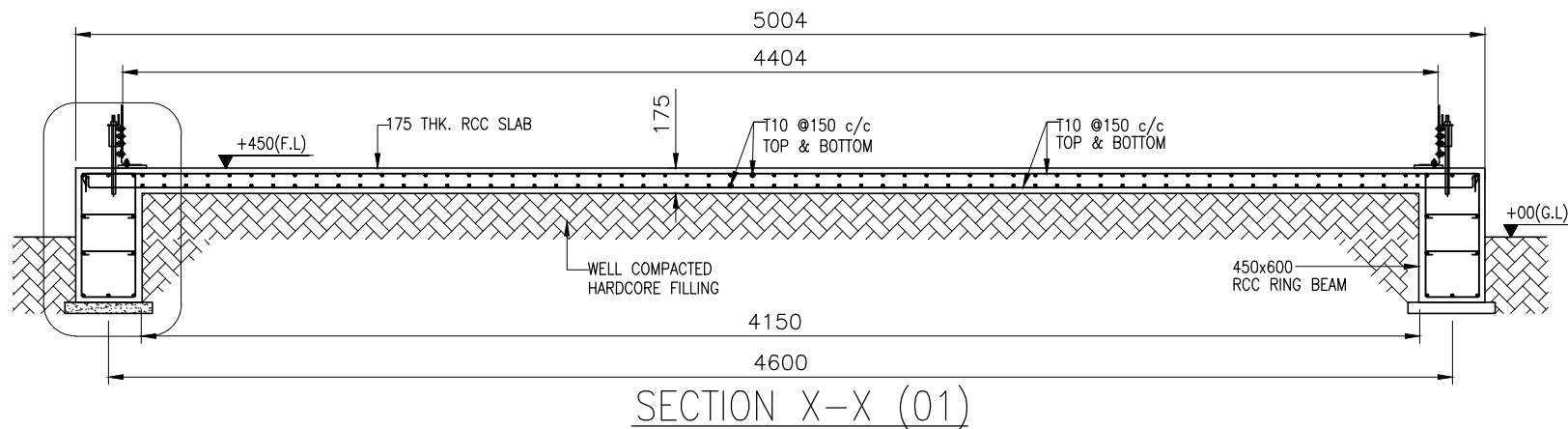
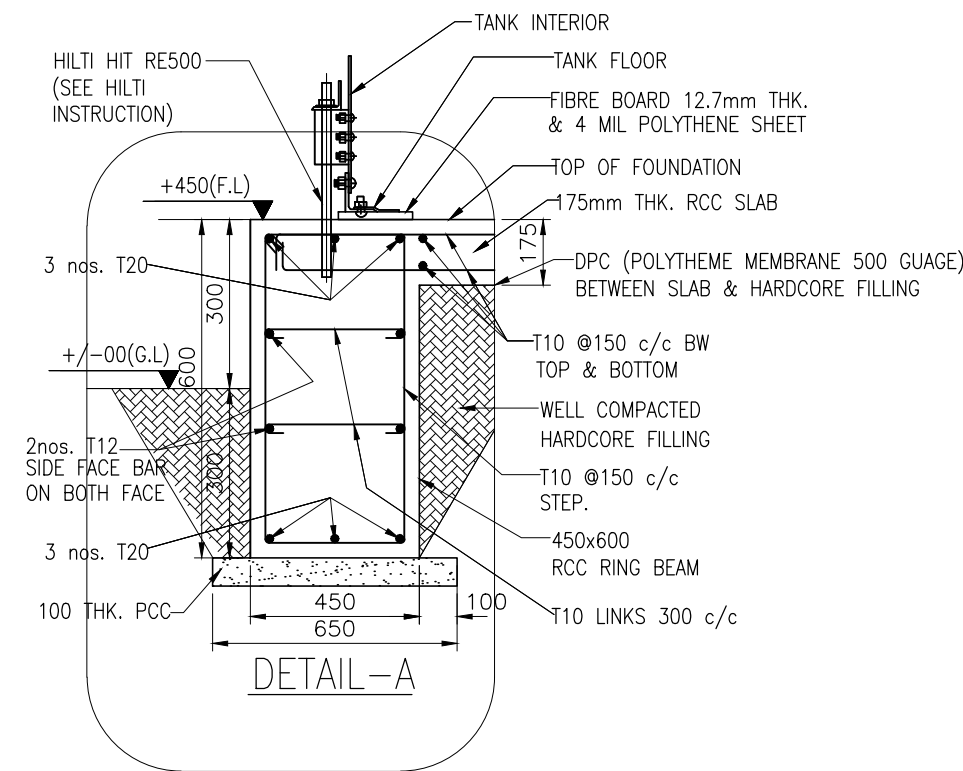

TREATED WATER TANK & FOUNDATION-ELEVATION

NOTES:-

- ALL DIMENSIONS ARE IN MILLIMETRES AND ALL LEVELS AER IN METRES, UNLESS OTHERWISE NOTED.
- DRAWINGS ARE NOT TO BE SCALED. ONLY WRITTEN DIMENSIONS ARE TO BE FOLLOWED.
- ALL CONCRETE WORK SHALL BE DESIGN GRADE C30.
- BLINDING CONCRETE WORK SHALL BE GRADE C10.
- ALL STRUCTURE WORK SHALL CONFORM TO BS 7668. GRADE 46A/ASTMA36. ALL STRUCTURAL MEMBERS SHALL BE HOT DIP GALVANIZED AND PAINTED AS PER SPECIFICATIONS.
- STEEL BARS DENOTED "T" SHALL BE HYSD BARS OF GRADE 460 CONFIRMING TO BS 4449
- NET SBC OF 15T/SQM IS CONSIDERED IN THE DESIGN.
- CLEAR COVER TO REINFORCEMENT
 - BEAM -40mm
 - SLAB -25mm

TENDER PURPOSE

					CLIENT	MINISTRY OF ENVIRONMENT AND ENERGY MALE REPUBLIC OF MALDIVES				
					PROJECT	PROVISION OF RAINWATER HARVESTING SYSTEM IN 10 ISLANDS				
					ASSIGNMENT	CONSULTANCY SERVICES FOR DESIGN AND SUPERVISION OF RAINWATER HARVESTING SYSTEM IN SH. NOOMARA, SH. BILEHFAH, SH. FEYDHOO, SH. FEEVAH, SH. NARUDHOO, SH. LHAIMAGU, SH. FUNADHOO, N. HENBADHOO, N. LHOHI, N. MAGOODHOO, MALDIVES [PACKAGE - 2]				
No.	DESCRIPTION				BY	DATE	APPR.			
REVISION										
DRAWING TITLE										
TYPICAL DRAWING OF TREATED WATER STORAGE TANK										
CONSULTANT										
SHAH TECHNICAL CONSULTANTS PVT. LTD., INDIA IN ASSOCIATION WITH DEVELOPMENT TECHNOLOGIES MALDIVES, MALDIVES										
APPROVED		CHECKED		DESIGNED		DRAWN		PDP		
SSS		SSS		SPP				PDP		
SCALE		DATE		DRAWING NUMBER		REVISION				
AS SHOWN		FEB 2018		Sh.Feevah/WS/08B		0				