

ELECTRICAL LEGEND

- ⌋ WALL MOUNT LIGHT
- ⌋ ONE WAY SWITCH (4GNG)

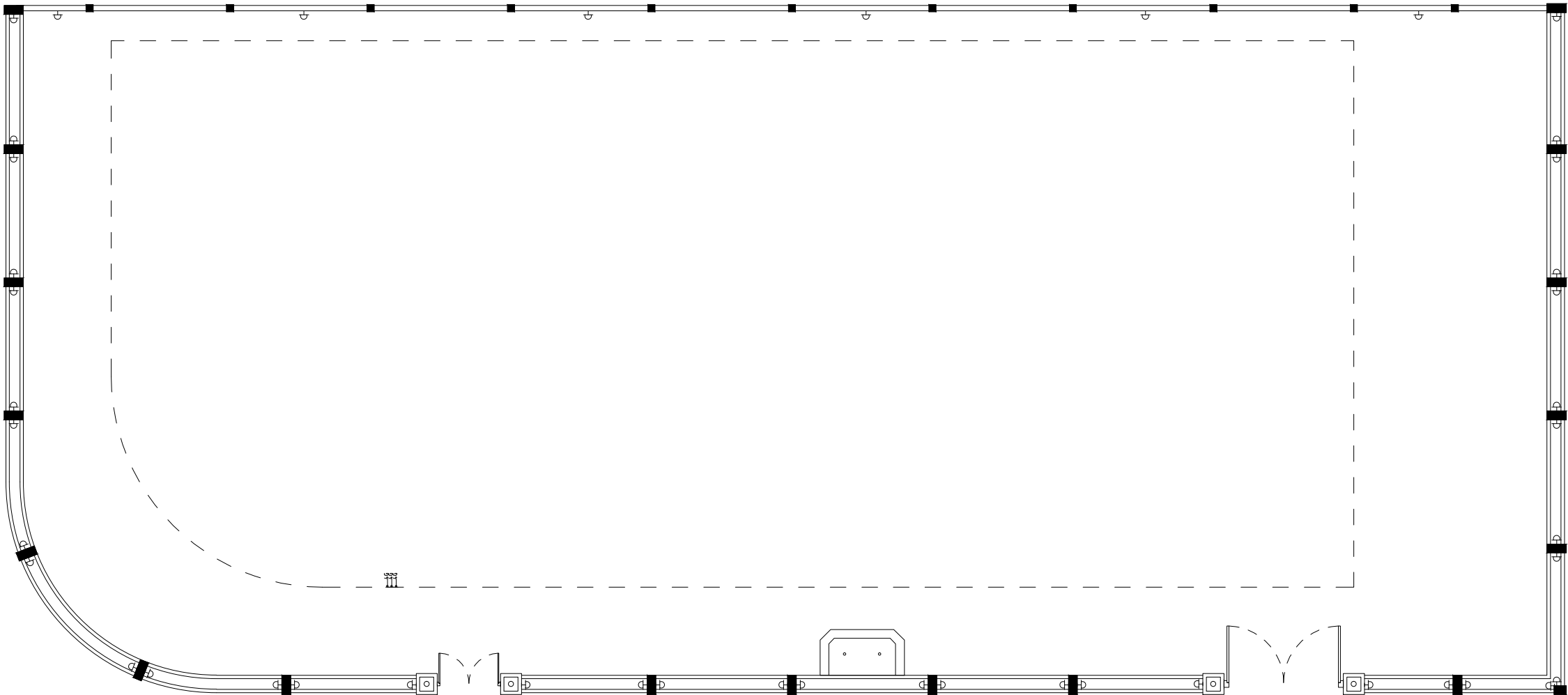

BOUNDARY WALL ELECTRICAL LAYOUT

SCALE 1:150

 INFRASTRUCTURE UNIT FINANCE DEPARTMENT MALDIVES POLICE SERVICE MALE' REPUBLIC OF MALDIVES	PROJECT TITLE	RECOMMENDATION APPROVED BY	DESIGN APPROVED BY	APPROVED BY	ARCHITECT / DESIGNER	DRAWN BY	DATE	DRAWING NO
	HULHUMALE' POLICE STATION NEIGHBORHOOD - 1	ISMAIL NAVEEN CHIEF SUPERINTENDENT OF POLICE	AZEEM WAHEED CHIEF INSPECTOR OF POLICE	AHMED MOHAMED CHIEF SUPERINTENDENT OF POLICE	ISMAIL RAFAEU POLICE STAFF SERGEANT STRUCTURAL ENGINEER RAMEEZ ADEPT MALDIVES PVT LTD	ISMAIL RAFAEU POLICE STAFF SERGEANT CHECKED BY ABDUL WAHID MOHAMED ADEPT MALDIVES PVT LTD	15 - 02 - 2015 REVISED DATE	SR 13 SHEET NO 48/

The drawings, concept and design contained are the properties of Maldives Police Service. Use of any kind of copy of whole or part of this drawing, concept or design or use on other projects or sites other than that specified on this drawing is strictly prohibited.