



2      ۰۰ / ۰۰ ۷۷  
         سرع سرع

نمبر	TES/2015/W-111	
No:		
پراجیکٹ	Construction of Customs Office Building at Ha. Uligam	
Project:		
تاریخ	Monday, August 17, 2015	
Issued Date		
نمبر صفحات: -11	Boq: - Soft Copy	نقشہ: - Soft Copy
No. of Pages:	Boq: - Soft Copy	Drawings: - Soft Copy

Please include this amendment when submitting the bid. بموجب هذا التعديل

1. Detail drawings of the Entrance Ramp, Water Storage Tank, Aluminum Doors & Windows, Reception Counter, GI Gate, Transparent Roofing (Main Entrance) and Ground Slab is provided with this amendment.
2. Please refer to Reception Counter for detail of fixed glass for counter.
3. Guard Room Structure is already shown in structural drawings.
4. For Guard Room location, please refer to the amended site plan.
5. Locations of Air-conditioning indoor and outdoor units is shown on the details attached.
6. For Kitchen Cupboard, please consider a “normal” standard kitchen cupboard.
7. Bidders should include the electrical main feeder cable and the length is approximately 375 feet from nearest distribution box.
8. Manufactured sand can be used for concrete and masonry works.
9. White sand can be used for block making.
10. There will be no major demolition work.
11. Storage on site can be arranged.
12. Please include cost for Flag Post in Additions Bill.
13. Please also include the following to the Additions Bill
  - a. Extend the building for further 5 feet from the back.
  - b. Extend the building for further 5 feet from the front.



14. The following changes are brought to the bid data.

ITB Clause Number	ITB Reference
19.1	<p>For <b><u>bid submission purposes</u></b> only, the Employer's address is:</p> <p>Mr. AHMED MUJUTHABA, Director General Tender Evaluation Section Ministry of Finance and Treasury Ameenee Magu Male', 20379 Republic of Maldives Tel: (960) 3349203, (960) 3349106 Fax: (960) 3320706, (960) 3324432 E-Mail: tender@finance.gov.mv</p> <p><b><u>The deadline for bid submission is:</u></b> Date: <b>Tuesday, August 25, 2015</b> Time: <b>1400 Hours Maldives Time</b></p>

اسم

Name: Abdullah Ali

اسم

Signature:



UNAUTHORIZED COPYING OR REPRODUCTION OF THIS DRAWING IS PROHIBITED AND WILL BE PROSECUTED TO THE FULL EXTENT OF THE LAW. THE CLIENT IS ENTITLED TO USE THE CONCEPT OR DESIGN IN THIS DRAWING. ANY OTHER USE OF THIS DRAWING WITHOUT THE WRITTEN PERMISSION OF THE ARCHITECT IS PROHIBITED AND WILL BE PROSECUTED TO THE FULL EXTENT OF THE LAW. THE ARCHITECT ASSUMES NO LIABILITY FOR ANY DAMAGE OR LOSS OF ANY KIND OR KIND OF PROPERTY, INCLUDING BUT NOT LIMITED TO, LOSS OF PROFITS, LOSS OF REVENUE, LOSS OF DATA, OR ANY OTHER DIRECT, INDIRECT, SPECIAL, INCIDENTAL, CONSEQUENTIAL, OR PUNITIVE DAMAGES, EVEN IF THE ARCHITECT HAS BEEN ADVISED OF THE POSSIBILITY OF SUCH DAMAGES. THE ARCHITECT'S LIABILITY IS LIMITED TO THE AMOUNT OF THE FEE PAID TO THE ARCHITECT FOR THE SERVICES PROVIDED. THE ARCHITECT'S LIABILITY IS LIMITED TO THE AMOUNT OF THE FEE PAID TO THE ARCHITECT FOR THE SERVICES PROVIDED. THE ARCHITECT'S LIABILITY IS LIMITED TO THE AMOUNT OF THE FEE PAID TO THE ARCHITECT FOR THE SERVICES PROVIDED.

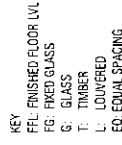

sheet title: **DOOR WINDOW SCHEDULE**  
 DETAILED DESIGN, ARCHITECTURAL DRAWINGS  
 scale: 1:50

date: 28-04-2013  
project no: CUS02-A02-302  
sheet no: A-06-19

COPYRIGHT: THE CONCEPT AND DESIGN IN THIS DRAWING ARE THE PROPERTY OF JDDA STUDIO. UNAUTHORIZED USE OF ANY KIND OR COPYING OF WHOLE OR PART OF THIS DRAWING IS PROHIBITED AND APPLYS OTHER THAN SPECIFIED ON THIS DRAWING IS PROHIBITED AND APPLYS AS TERMS AND CONDITIONS UNDER WHICH THE CLIENT IS ENTITLED TO USE THE CONCEPT OR DESIGN IN THIS DRAWING.

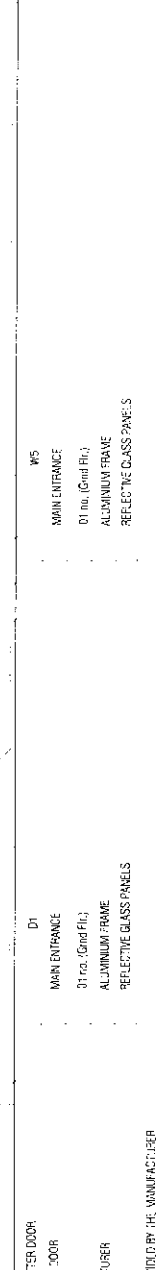
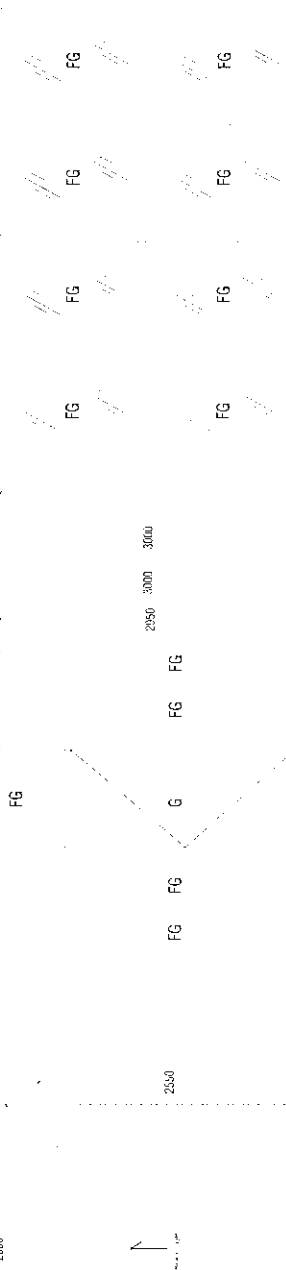
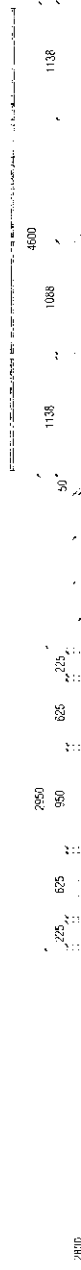

KEY  
FGL: FINISHED FLOOR LVL  
FG: FIXED GLASS  
G: GLASS  
T: TIMBER  
L: LOUVERED  
EQ: EQUAL SPACING

QTY.	DESCRIPTION	UNIT	PRICE	TOTAL
1	ROLLER SHUTTER DOOR			
1	AUTOMATIC ROLLER SHUTTER DOOR			
1	01 no. (Gind Flg.)			
1	PRODUCED BY THE MANUFACTURER			
1	ALUMINIUM FRAME			
1	REFLECTIVE GLASS PANELS			
1	ALL DETAILS ARE TO BE PROVIDED BY THE MANUFACTURER			

W5	
MAIN ENTRANCE	-
01 Inu. (Grid Flr.)	-
ALUMINUM FRAME	-
REFLECTIVE GLASS PAN	-

53  
54

ALL DETAILS ARE TO BE PROVIDED BY THE MANUFACTURER

contractors shall work from figured dimensions only.  
discrepancies must be reported immediately to the architects.  
contractors must check all dimensions on site.



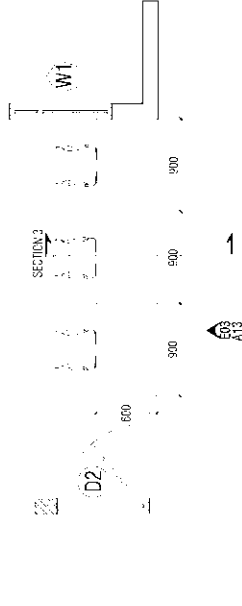

COUNTER DETAILS - DETAIL 02

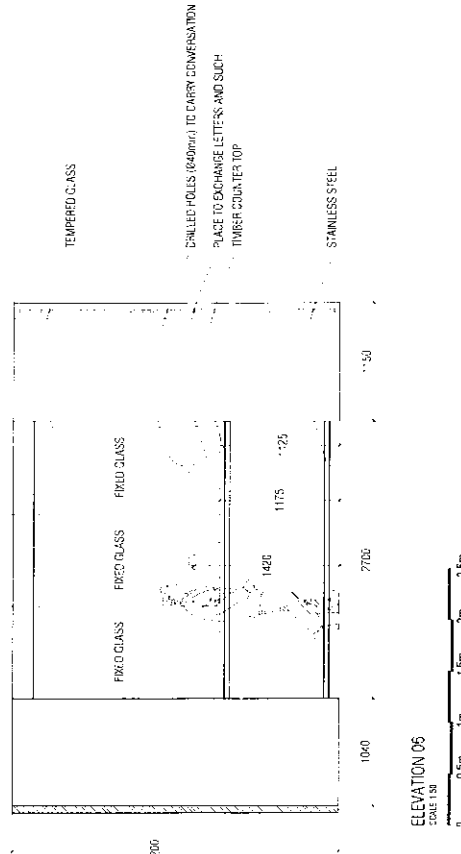
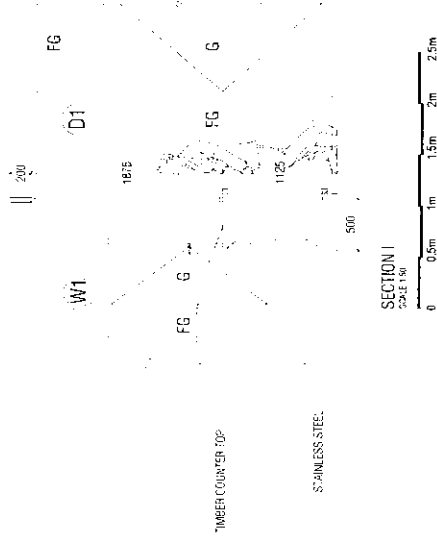

contractors shall work from figured dimensions only.  
discrepancies must be reported immediately to the architects  
contractors must check all dimensions on site.

sheet title **DOOR WINDOW SCHEDULE**

DETAILED DESIGN, ARCHITECTURAL DRAWINGS

scale 1:50

revision:

A	28-03-2013
B	
C	

architect:

SHIVAZ

strang.

SAVINOON

client:

THAHSEEN

project title:

PROPOSED SINGLE STORY BUILDING

project no:

CUS02-A02-302

date:

28-04-2013

sheet no:

A-16-19

4000

29000

R6@150 C/C  
R6@150 C/C



ENTRANCE DETAIL

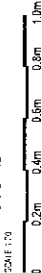

contractors shall work from figured dimensions only.  
discrepancies must be reported immediately to the architects.  
contractors must check all dimensions on site.

sheet title: DETAILS

DETAILED DESIGN ARCHITECTURAL DRAWINGS  
scale: 1:20

revision  
A: 26-05-2013  
B: E.E.  
C: E.E.

architect:  
int. designer:  
checked by: ---

SHWAZ

streng: SAMNOON  
serv. eng: ARIF  
drawn by: THAHSEEN

project title: PROPOSED SINGLE STORY BUILDING  
CUSTOMS OFFICE AND ACCOMMODATION, HALJUGAMU  
client: MALDIVES CUSTOMS SERVICE

date: 28-04-2013  
project no: CUS02-A02-302  
sheet no: A-17-19



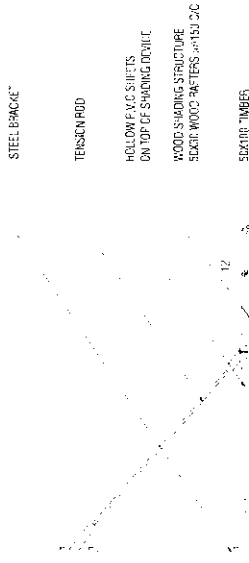

TRANSPARENT ROOFING - DETAIL  
SCALE 1:20

contractors shall work from figured dimensions only.  
discrepancies must be reported immediately to the architects.  
contractors must check all dimensions on site.

sheet title: DETAILS

DETAILED DESIGN ARCHITECTURAL DRAWINGS

scale: 1:20

revision:  
A. 28-03-2013  
B.  
C.

architect:  
int. designer:  
checked by:

SHWAZ

serv. eng:  
drawn by:

SAWMOON  
ARIF  
THANSEEN

project title: PROPOSED SINGLE STORY BUILDING  
CUSTOMERS OFFICE AND ACCOMMODATION, HA JIJGAMU  
client: MALDIVES CUSTOMS SERVICE

date: 28-04-2013  
project no: CUS02-A02-302  
sheet no: A-18-19

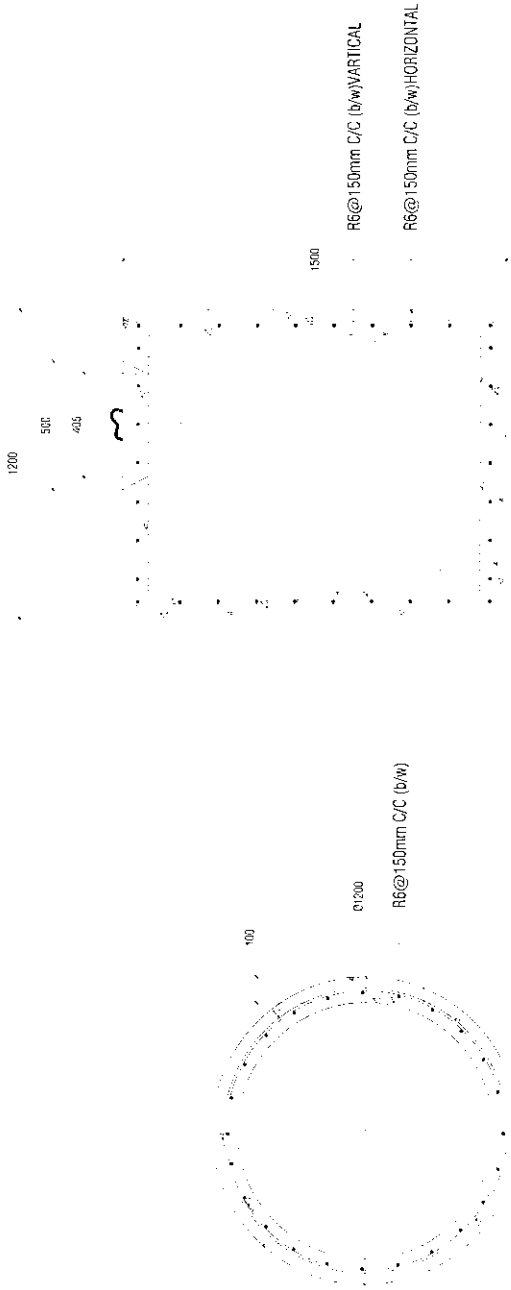

WELL SECTION TOP VIEW PLAN

WELL SECTION SIDE VIEW PLAN

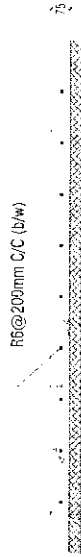

Damp proof membrane

Compacted earth

GROUND SLAB DETAIL

NOTE  
-DEPTH OF WELL: 1500 mm  
CONCRETE SURFACES EXPOSED TO GROUND, RAIN AND SEA WATER SHOULD  
BE APPLIED WITH TWO LAYERS OF DAMP PROOFING AGENT.

contractors shall work from figured dimensions only.  
discrepancies must be reported immediately to the architects.  
contractors must check all dimensions on site.

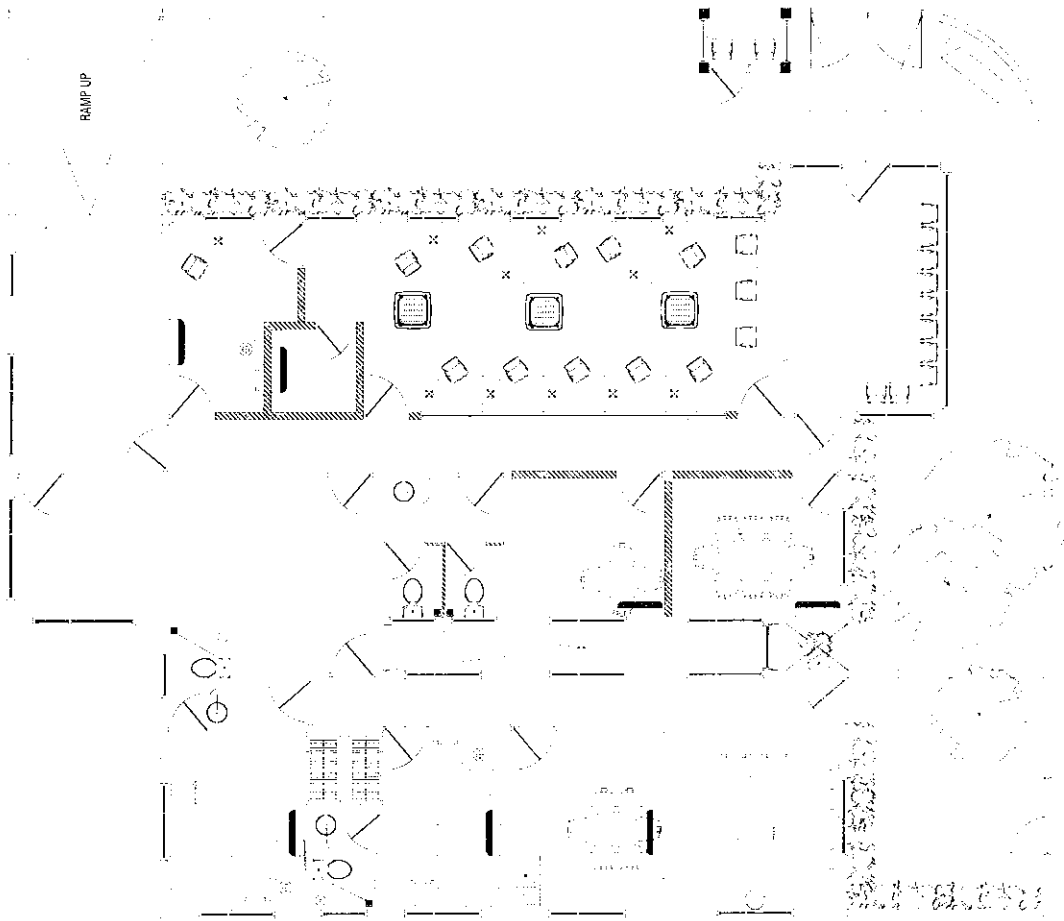

- CEILING CASSETTE TYPE INDOOR UNIT
- WALL MOUNT INDOOR UNIT
- AC OUTDOOR UNIT

NOTE: ALL OUTDOOR UNITS TO BE INSTALLED ON THE ROOF



discrepancies must be reported immediately to the architects.  
contractors must check all dimensions on site.