

PROJECT:

CONSTRUCTION OF  
GA. VILLIGILI HARBOR

CONTENTS:

Quay Wall Corner  
Block Details

DRAWING NO.:

002

SCALE:

1 : 50

DATE:

04 AUG 2015



ENGINEERING DIVISION  
MINISTRY OF HOUSING AND INFRASTRUCTURE  
AMEENEE MAGU, MALE' 20392  
REPUBLIC OF MALDIVES  
TEL: 300 4300, FAX: 300 4301

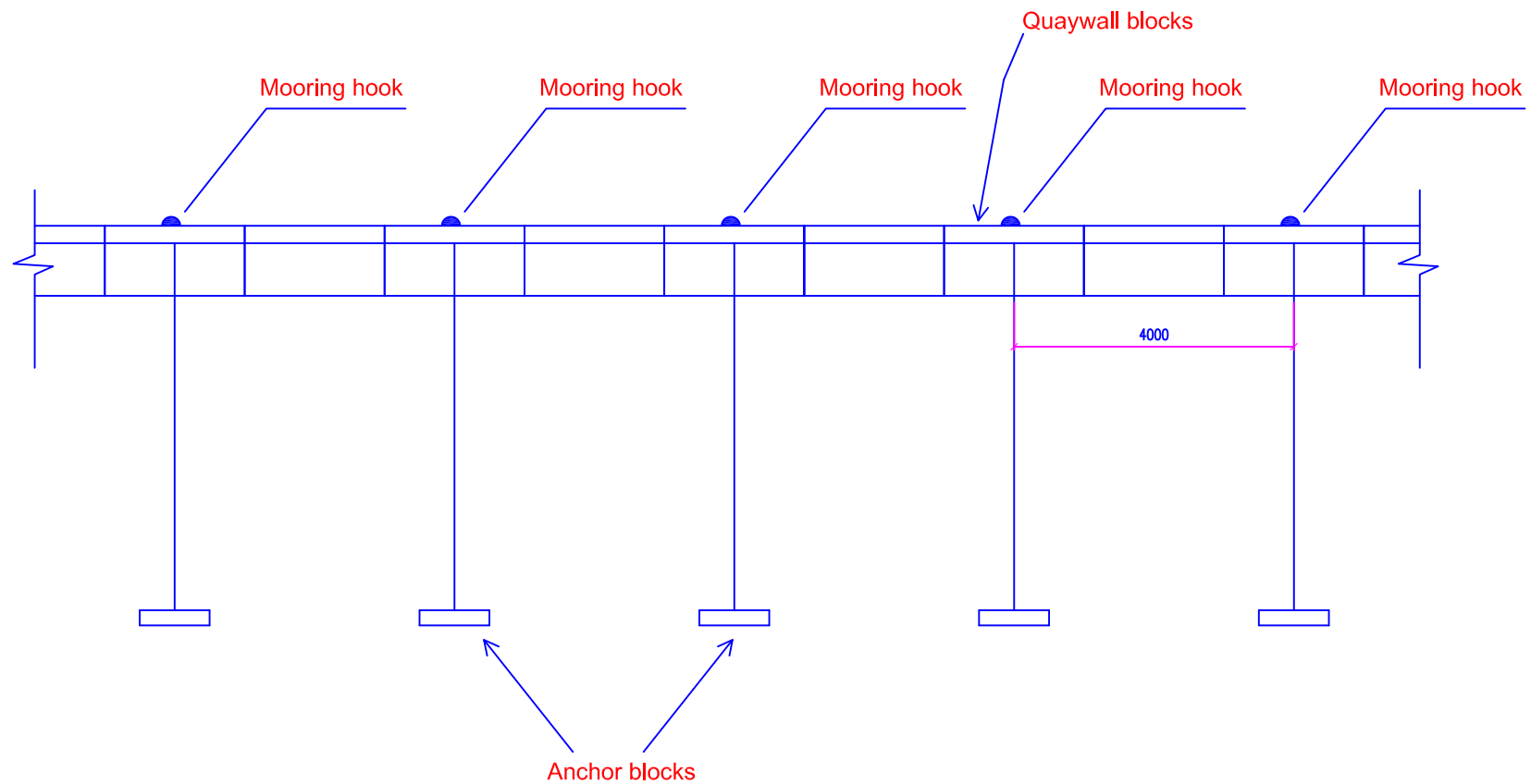

PROJECT:

CONSTRUCTION OF  
GA. VILLIGILI HARBOR

CONTENTS:

Mooring Hook  
Installation Layout

DRAWING NO.:

004

SCALE:

NTS

DATE:

04 AUG 2015



ENGINEERING DIVISION  
MINISTRY OF HOUSING AND INFRASTRUCTURE  
AMEENEE MAGU MALE' 20392  
REPUBLIC OF MALDIVES  
TEL: 300 4300, FAX: 300 4301

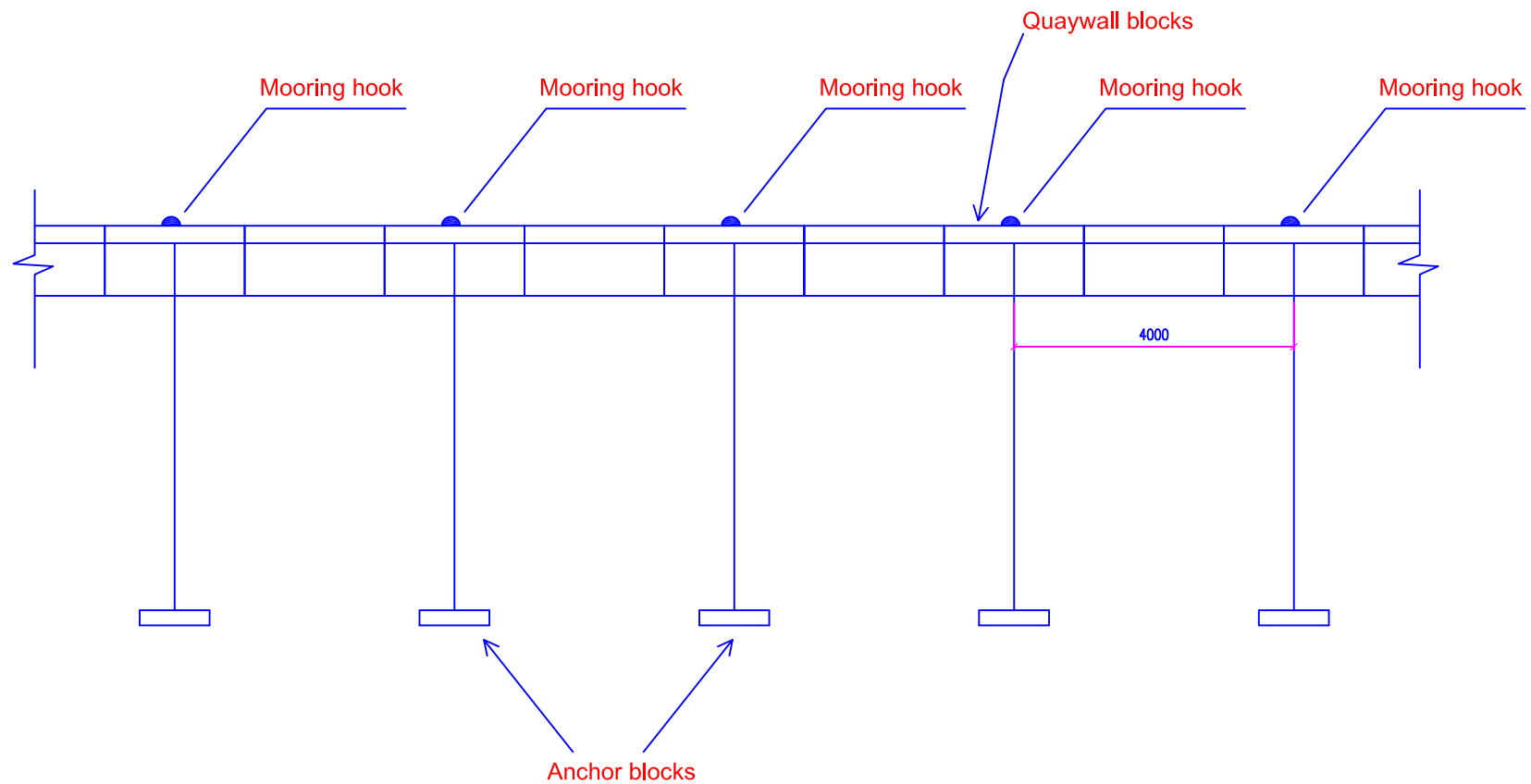

PROJECT:  
CONSTRUCTION OF  
GA. VILLIGILI HARBOR

CONTENTS:  
Mooring Hook  
Installation Layout

DRAWING NO.:  
004

SCALE:  
NTS

DATE:  
04 AUG 2015



ENGINEERING DIVISION  
MINISTRY OF HOUSING AND INFRASTRUCTURE  
AMEENEE MAGU MALE' 20392  
REPUBLIC OF MALDIVES  
TEL: 300 4300, FAX: 300 4301

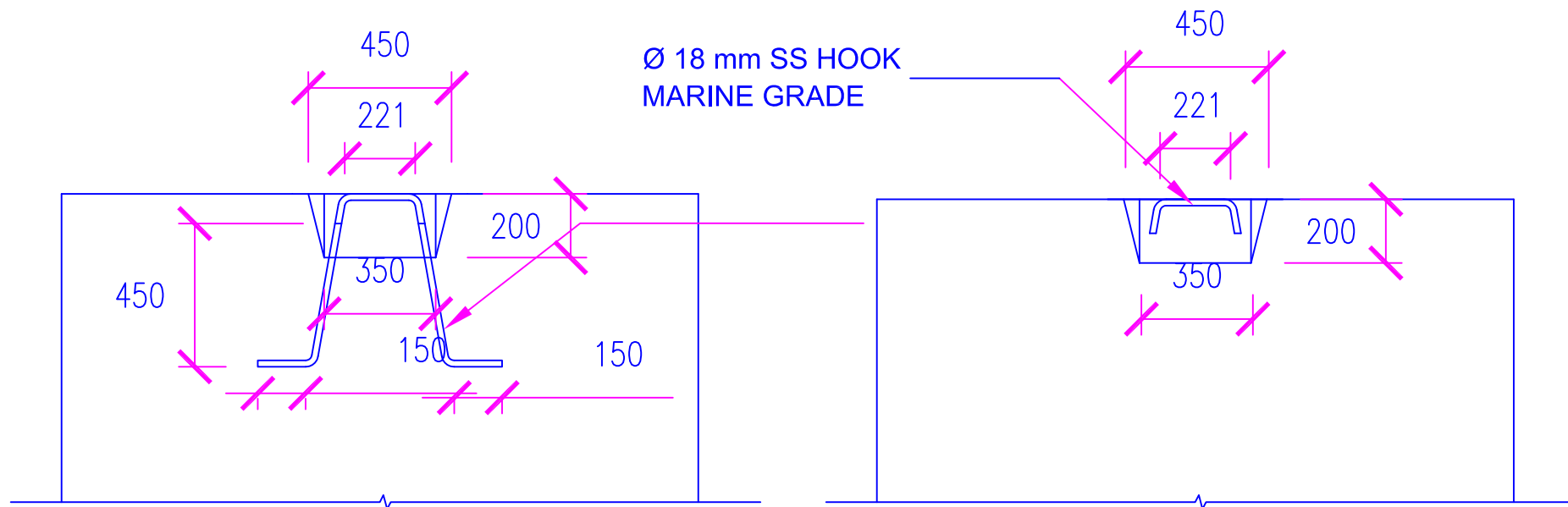

**MOORING HOOK PLAN**

**MOORING HOOK ELEVATION**

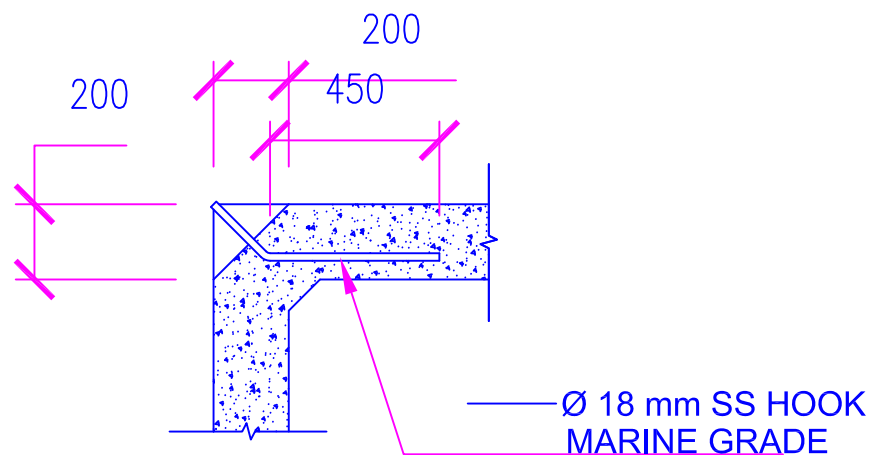

**MOORING HOOK SECTION**

PROJECT:  
CONSTRUCTION OF  
GA. VILLIGILI HARBOR

CONTENTS:  
Quaywall Mooring  
Hooks

DRAWING NO.:  
005

SCALE:  
1 : 20

DATE:  
04 AUG 2015



ENGINEERING DIVISION  
MINISTRY OF HOUSING AND INFRASTRUCTURE  
AMEENEE MAGU 'MALE' 20392  
REPUBLIC OF MALDIVES  
TEL: 300 4300, FAX: 300 4301

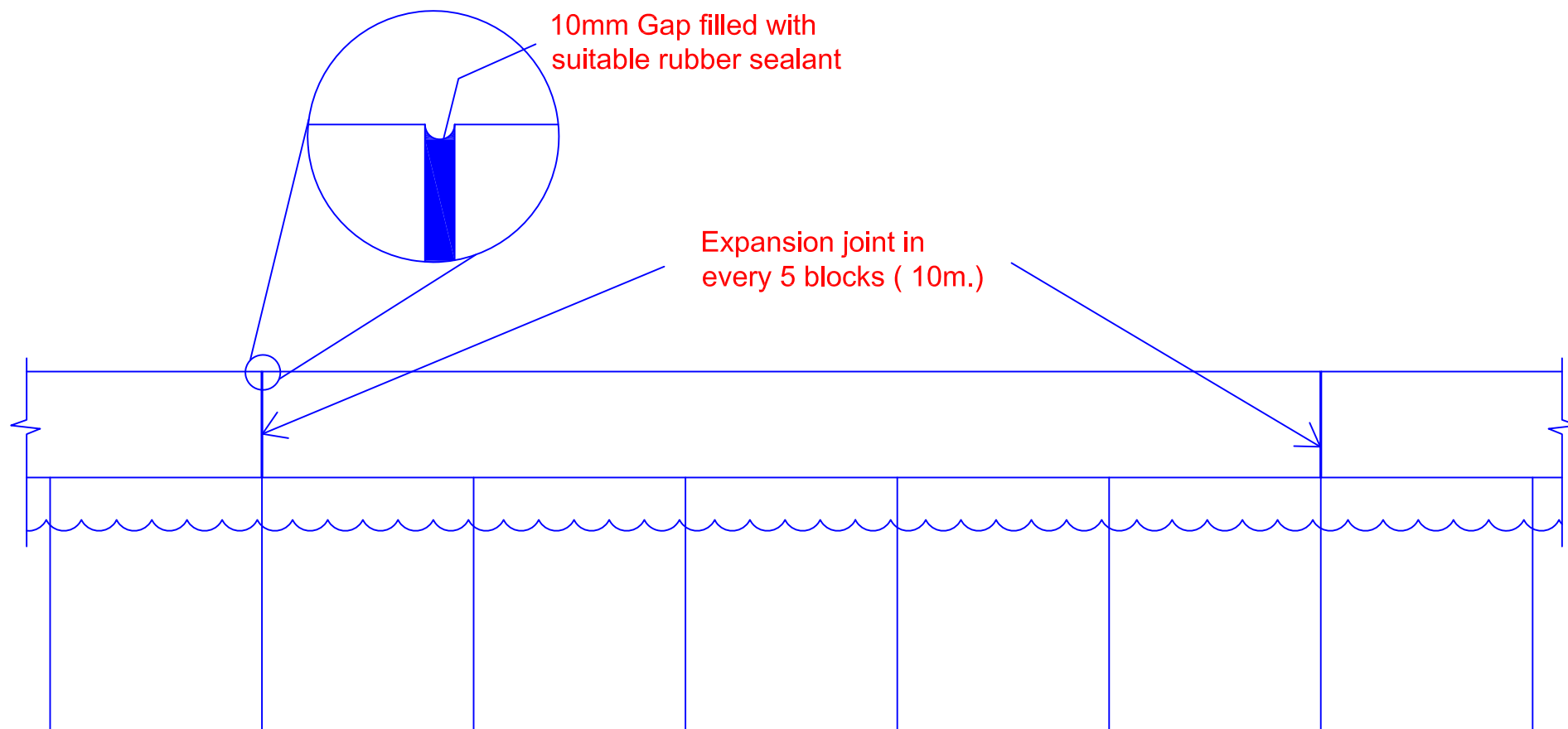

PROJECT:

CONSTRUCTION OF  
GA. VILLIGILI HARBOR

CONTENTS:

Quay Wall Expansion  
Gap Detail

DRAWING NO.:

006

SCALE:

NTS

DATE:

04 AUG 2015



ENGINEERING DIVISION  
MINISTRY OF HOUSING AND INFRASTRUCTURE  
AMEENE MAGU MALE' 20392  
REPUBLIC OF MALDIVES  
TEL: 300 4300, FAX: 300 4301

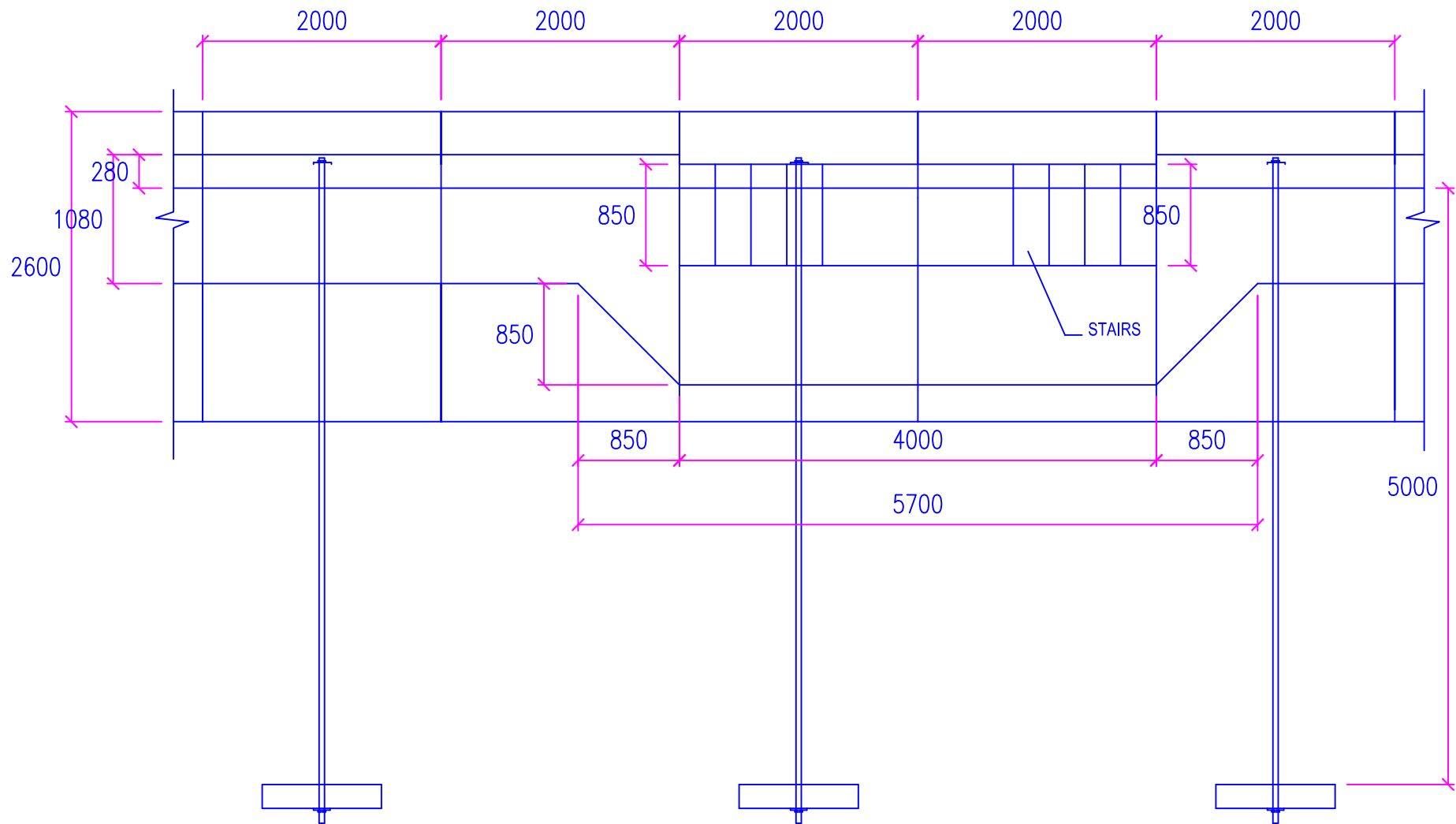

### QUAY WALL & STAIRCASE PLAN

PROJECT:  
CONSTRUCTION OF  
GA. VILLIVGILI HARBOR

CONTENTS:  
Quaywall Staircase  
Plan

DRAWING NO.:  
007

SCALE:  
1 : 50

DATE:  
04 AUG 2015



ENGINEERING DIVISION  
MINISTRY OF HOUSING AND INFRASTRUCTURE  
AMEENEE MAGU MALE' 20392  
REPUBLIC OF MALDIVES  
TEL: 300 4300, FAX: 300 4301

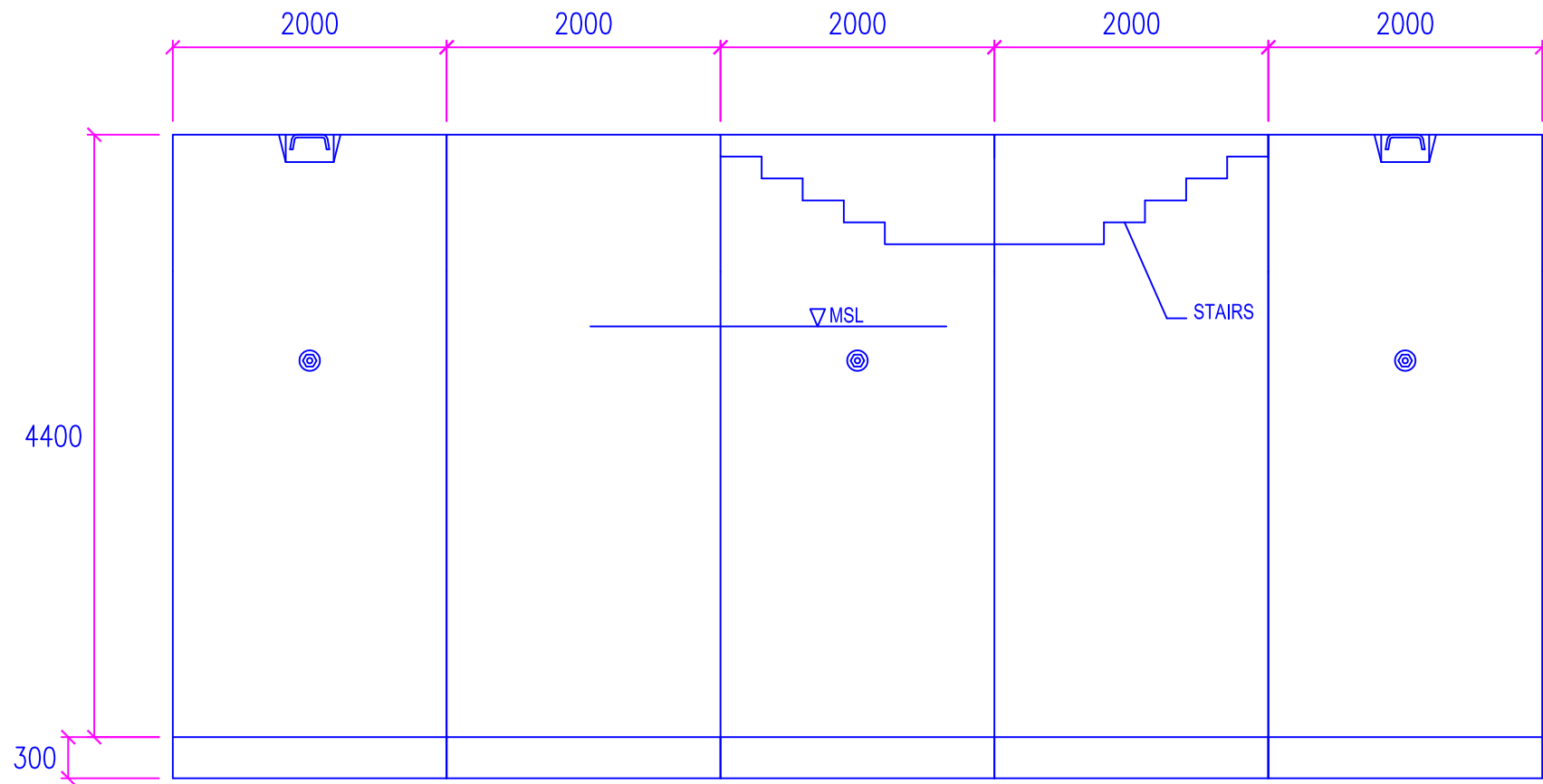

PROJECT:  
CONSTRUCTION OF  
GA. VILLIGILI HARBOR

CONTENTS:  
Quay Wall Staircase  
Front Elevation

DRAWING NO.:  
008

SCALE:  
1 : 50

DATE:  
04 AUG 2015



ENGINEERING DIVISION  
MINISTRY OF HOUSING AND INFRASTRUCTURE  
AMEENE MAGU MALE' 20392  
REPUBLIC OF MALDIVES  
TEL: 300 4300, FAX: 300 4301



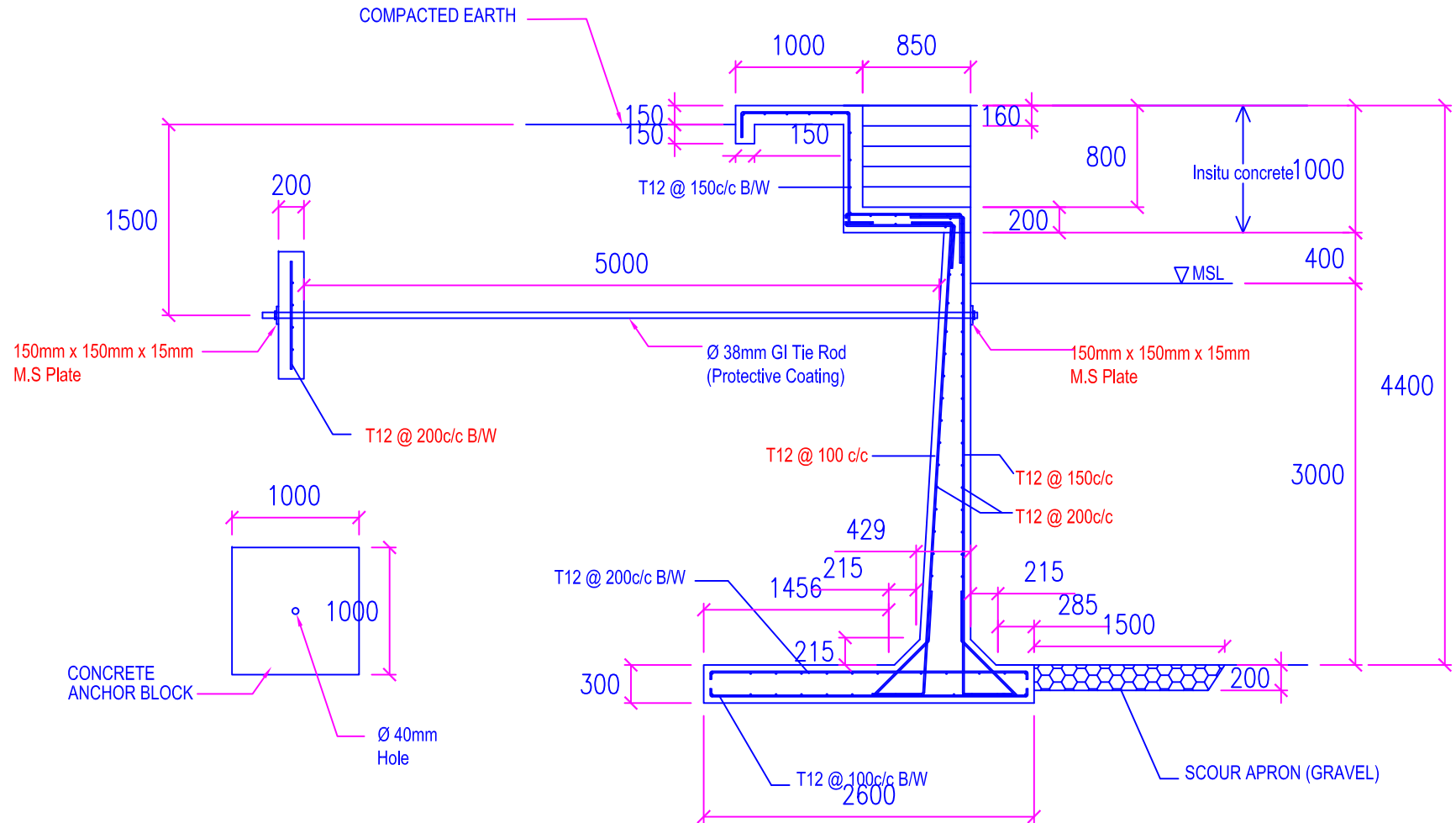

## STAIR DETAIL

SCALE 1 : 50

PROJECT:  
CONSTRUCTION OF  
GA. VILLIGILI HARBOR

CONTENTS:  
Quay Wall Stair Detail

DRAWING NO.:  
009

SCALE:  
1 : 50

DATE:  
04 HARBOR 2015



ENGINEERING DIVISION  
MINISTRY OF HOUSING AND INFRASTRUCTURE  
AMEENEE MAGU MALE' 20392  
REPUBLIC OF MALDIVES  
TEL: 300 4300, FAX: 300 4301

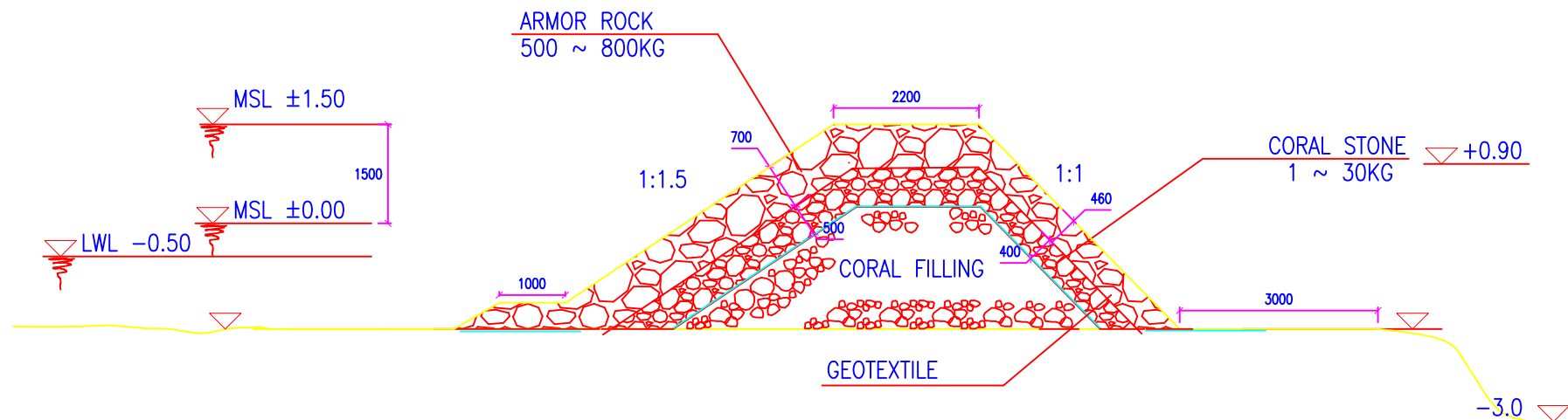

PROJECT:

CONSTRUCTION OF  
GA. VILLIGILI HARBOR

CONTENTS:

Breakwater  
Sections

DRAWING NO.:

010

SCALE:

NTS

DATE:

04 AUG 2015



ENGINEERING DIVISION  
MINISTRY OF HOUSING AND INFRASTRUCTURE  
AMEENEE MAGU MALE' 20392  
REPUBLIC OF MALDIVES  
TEL: 300 4300, FAX: 300 4301

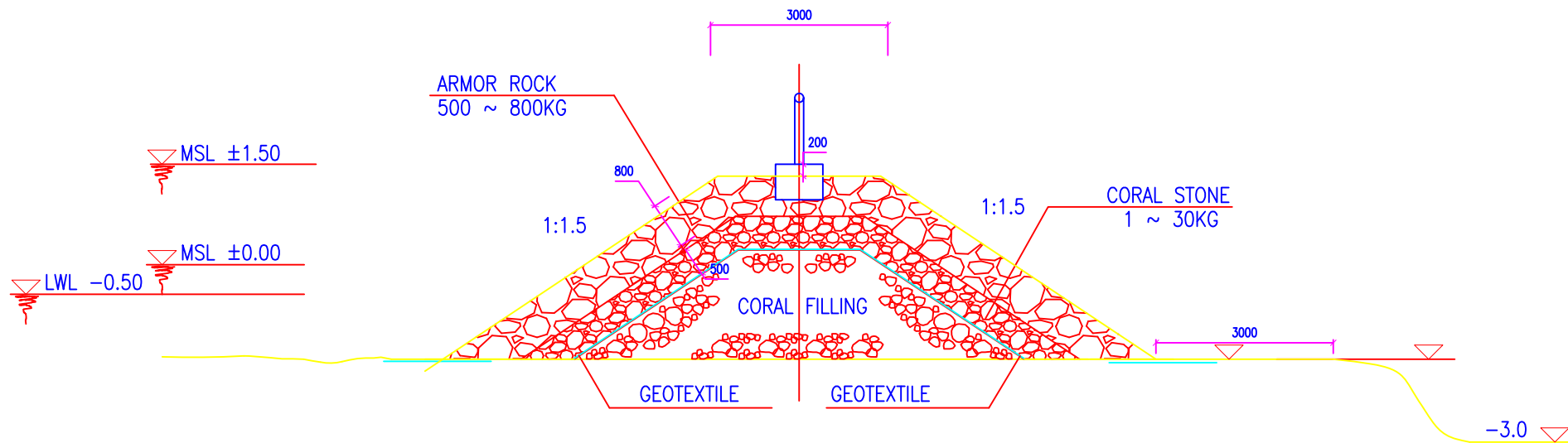

PROJECT:

CONSTRUCTION OF  
GA. VILLIGILI HARBOR

CONTENTS:

Breakwater  
Sections

DRAWING NO.:

011

SCALE:

NTS

DATE:

04 AUG 2015



ENGINEERING DIVISION  
MINISTRY OF HOUSING AND INFRASTRUCTURE  
AMEENEE MAGU MALE' 20392  
REPUBLIC OF MALDIVES  
TEL: 300 4300, FAX: 300 4301

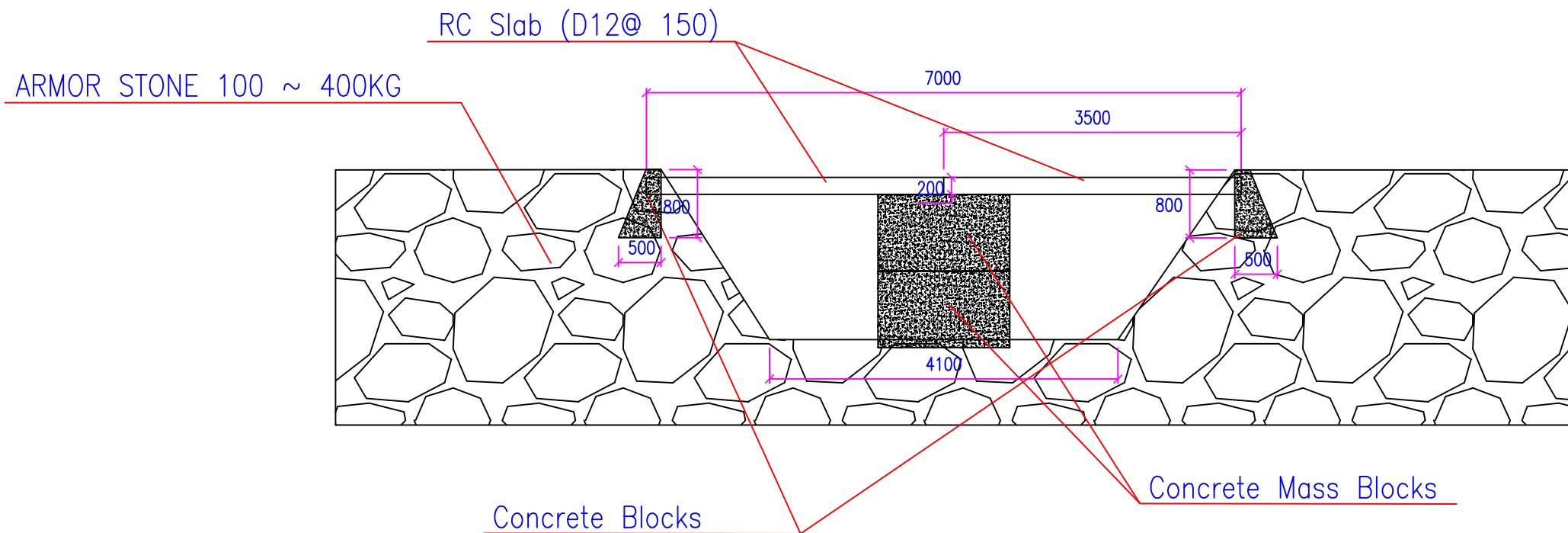

PROJECT:  
CONSTRUCTION OF  
GA. VILLIGILI HARBOR

CONTENTS:  
CULVERT  
Sections

DRAWING NO.:  
012

SCALE:  
NTS

DATE:  
04 AUG 2015



ENGINEERING DIVISION  
MINISTRY OF HOUSING AND INFRASTRUCTURE  
AMEENEE MAGU MALE' 20392  
REPUBLIC OF MALDIVES  
TEL: 300 4300, FAX: 300 4301

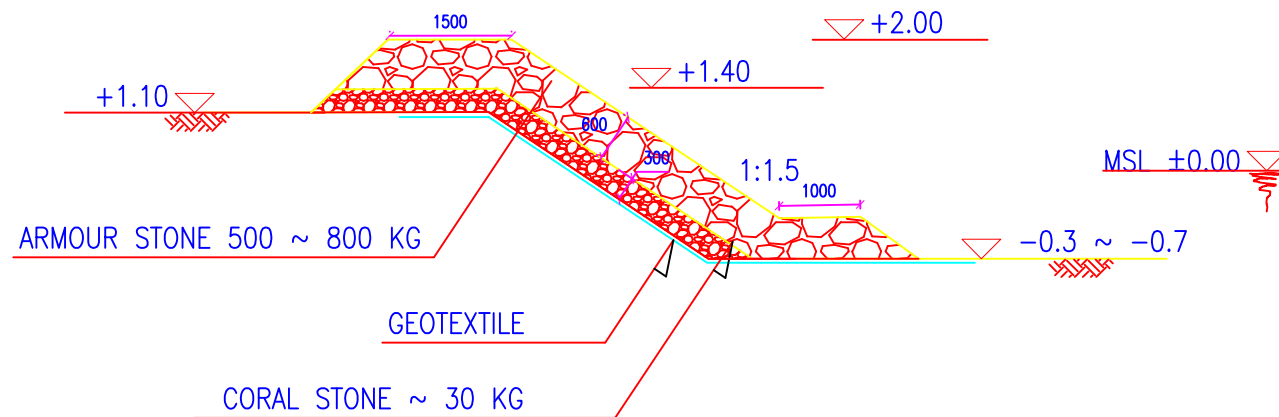

PROJECT:

CONSTRUCTION OF  
GA. VILLIGILI HARBOR

CONTENTS:

REVETMENT  
Sections

DRAWING NO.:

013

SCALE:

NTS

DATE:

04 AUG 2015



ENGINEERING DIVISION  
MINISTRY OF HOUSING AND INFRASTRUCTURE  
AMEENEE MAGU MALE' 20392  
REPUBLIC OF MALDIVES  
TEL: 300 4300, FAX: 300 4301